

Precision Regulator Festo LRP 1/4 0.7-EX4
MAP-40-1-1/8-EN Pressure regulator + Gauge

Solenoid valve
Festo MFH-3-1/8-EX
Moisture Filter Festo
MS4-LF-1/4-AGB-ERV-EX4

Safety switch Schmersal EX-BNS250-12Z-2187-3G/D

Typ plate
Earth lug
Precision Regulator Festo LRP 1/4 0.7-EX4
MAP-40-1-1/8-EN Pressure regulator + Gauge

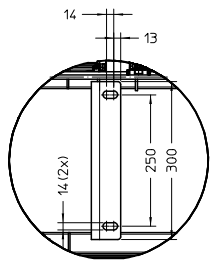

Z
Schaal 1:5

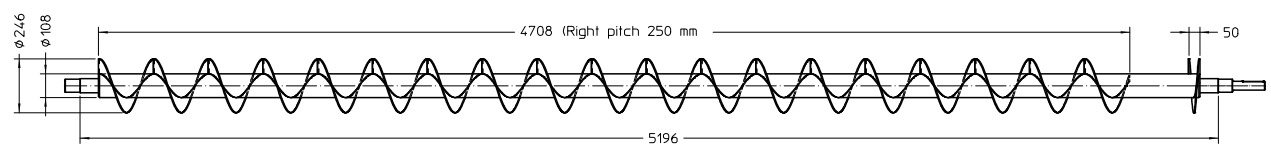
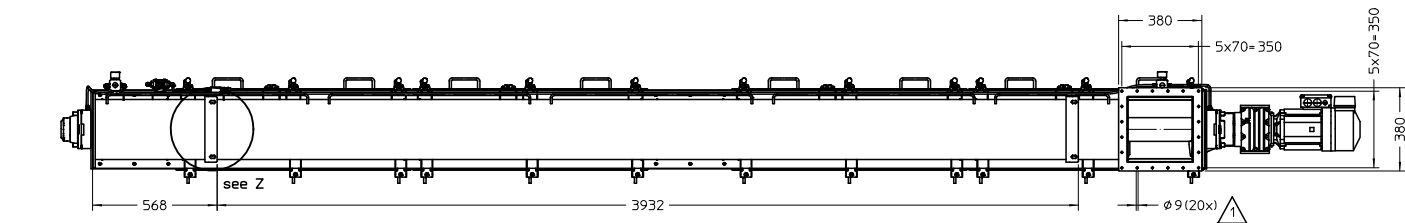

SPECIFICATION	
TAG nr.	-
Product	Whole milk powder
Bulk density (ton/m3)	0,4 - 0,6
Capacity (m3/hour) Nom.	30
Capacity (ton/hour) Nom.	12,35 - 18,52
Starting pitch / Main pitch (mm)	- / 250
Filling rate (%)	78
Transmission (type)	Hollow shaft
Gearmotor	SEW FA67/II2GD EDRN100LS4/3D/TF/VE
Voltage (Volt)	230/400
Power(kW)	2.2
IP Class	55
Frequency (Hertz)	50 (VFD)
Thermal class	F
Gearmotor RPM	79
Lubricant	Standard
Colour	RAL 9010
External cooling fan	230/400V 50Hz
Screw RPM	79
Wall clearance (mm)	11
Welds Screw	Both sides fully welded
Welds Screw housing	Both sides fully welded
Lubricant bearings	Foodgrade (White)
Seal Drive side	Air seal
Seal End side	Air seal
Preservation Screw housing external	Wet blasting
Preservation Screw housing internal	Sanded Ra 0.8 directionless
Preservation Screw	Sanded Ra 0.8 directionless

ATEX	II 1/3 D c T120°C
IECEX	zone 22
Frequency range (Hz)	10 - 50
Frequency maximum (Hz)	50
Tipspeed @50Hz (m/s)	0.97
Tipspeed @maxHz (m/s)	1.0

vanBeek Division Hagerman 30
THE STANDARD IN SCREW CONVEYING

Order: **690834**
 Tekening: **690834.A.001**
 1

Copyright © 2019 vanBeek B.V. Alle rechten voorbehouden. Het gebruik van dit document is beperkt tot de afgeleverde bestelling.